



SMART DEVICES CATALOG



Connectica IoT Pvt Ltd India

Solutions Provided by Connectica Singapore

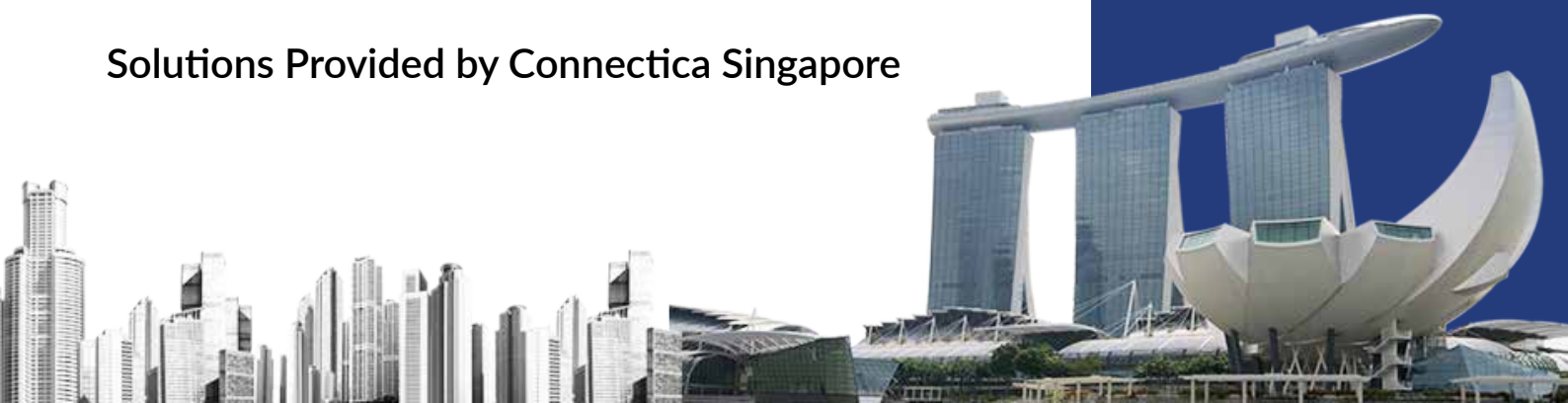

TABLE OF CONTENTS

Page No

03	ABOUT CONNECTICA WHO WE ARE OUR MISSION, VISION & GOAL
05	SMART SOLUTIONS FOR EVERY SPACE
08	OUR PRODUCTS SMART LOCKS SMART SWITCHES SMART SENSORS IR REMOTE CONTROL SMART CURTAINS
23	CONNECTICA APPLICATION
25	CONTACT US

SMART LIVING STARTS WITH CONNECTICA

WHO WE ARE

Connectica is an emerging provider of innovative smart solutions that empower individuals and businesses to create smarter, more efficient, and secure environments.

Our comprehensive suite of integrated solutions addresses a wide range of needs across various sectors, including smart homes, smart offices, smart retail, and advanced security systems.



With headquarters in Singapore and regional offices in India (Gurugram) and Malaysia, we provide innovative smart home, smart office, smart retail, security, and IoT solutions. We continuously strive to improve IoT-enabled solutions and seamless automation experiences that transform the way people live and work.

Experience the future of living and working with Connectica, where innovation meets reliability, and every space becomes a smarter, more efficient reality.



OUR MISSION

We strive to make smart living accessible to all, fostering a thriving ecosystem of connected spaces. Dedicated in providing innovative, user-friendly, and secure smart technology solutions for homes, offices, hotels, resorts and more in India.



OUR VISION

To empower people with seamless smart solutions that elevate their lifestyle experiences, shaping a future of effortless convenience and peace of mind.



OUR GOAL

To become the leading provider of integrated smart solutions. Achieve market leadership by offering a comprehensive suite of smart home, smart office, and security solutions.

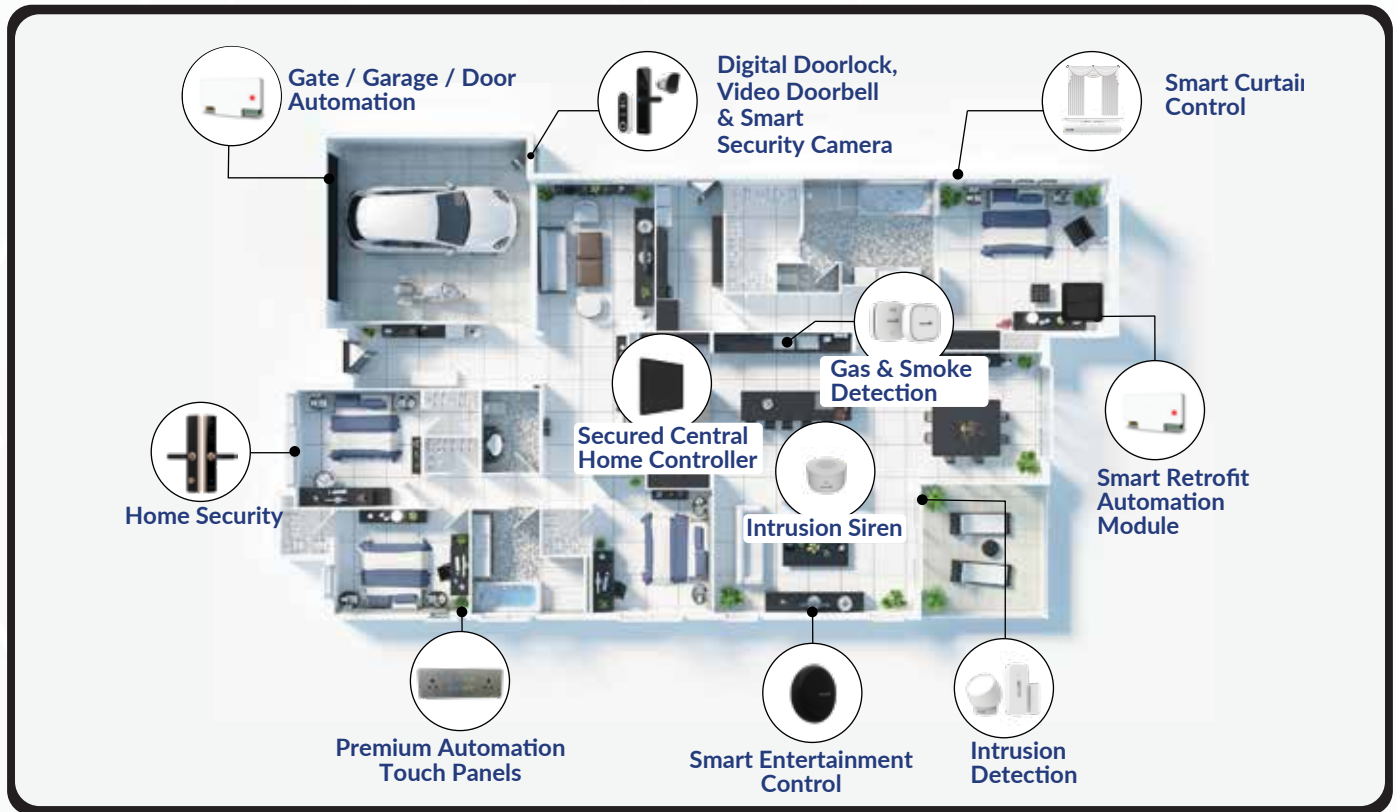

SOLUTIONS FOR ALL TYPES OF PROPERTIES



MODERN HOME



OFFICES



HOTELS & RESORTS

We begin by understanding each customer's unique needs and craft intelligent solutions that integrate with their lifestyle. From homeowners enhancing comfort, security, and energy efficiency to businesses and hotels embracing scalable, futuristic automation, our expertise transforms ordinary spaces into connected ecosystems.

With smart technology and innovative designs, we bring the future into your home or workplace. Change to a smarter way of interacting with your environment. Experience tomorrow, today.

CUSTOMER KEY BENEFITS WITH SMART AUTOMATION



Cutting-Edge Technology at Your Fingertips

Experience state-of-the-art home automation with Connectica's advanced technology. Our AI-driven systems offer voice control, real-time monitoring, and a unified platform for effortless management of everything—from lighting to security. Connectica keeps you connected and in control, wherever you are.



Connectica

Seamless Integration with your lifestyle

Connectica offers smart home solutions specifically designed to complement Indian living. Our systems manage power fluctuations and adapt to diverse weather patterns, whether in modern apartments or traditional bungalows. Connectica seamlessly integrates with your lifestyle, providing comfort and convenience tailored to Indian households.



Energy Efficiency That Saves You Money

Connectica doesn't just make your home smarter; it makes it greener. Our intelligent systems optimize energy use to reduce your electricity bills and environmental impact. Choose sustainable living with Connectica, where smart solutions benefit both your wallet and the planet.

Enhanced Security for Complete Peace of Mind

Security is our top priority. Connectica offers 24/7 monitoring, real-time alerts, and remote access to your home's security systems, so you can have peace of mind whether you're at work or away on vacation. Advanced cameras, motion sensors, and automated locks safeguard your home and loved ones.



Tailored Elderly and Family Care Solutions

Connectica provides smart solutions to monitor the well-being of elderly family members from a distance. With features like emergency alerts and automated health reminders, our systems ensure that loved ones receive the care they need, even when you're not there.



Effortless Entertainment and Ambiance Control

Enjoy a personalized entertainment experience with Connectica's smart home solutions. Control your music, TV, and lighting to create the perfect ambiance with a simple command. Connectica brings immersive entertainment into every room, transforming your home into the ultimate relaxation space.



SMART LOCKS

Connectica's smart locks offer advanced security solutions for every type of door-whether it's a deadbolt, rim lock, mortise, gate, or glass door. Our locks provide keyless entry, enhanced protection, and seamless integration with existing door mechanisms, ensuring convenience and peace of mind for every home or business.



Fingerprint



Pin Code



Card Unlock



Mechanical Key



APP Unlock



3D Face Recognition



Smart Doorlock With Fingerprint Sensor

- Unlock via the Connectica app, M1 card, fingerprint, passcode, or mechanical key for maximum convenience.
- Slim, modern panel fits most wooden and sliding doors for a sleek and versatile look.
- One-touch Biometric Fingerprint sensor for fast, secure access.
- Multi-level administrator settings and emergency power supply ensure security, even during power outages.



Color



Grey



Gold

Model No

L6-FP-145-W

L6-FP-144-W

Unlock

Methods



Fingerprint



Pin
Code



Card
Unlock



Mechanical
Key



APP
Unlock

Features



Energy
Efficient



Real-time
Video
Intercom



Multiple
Access
Options



Easy
Installation



Smart
Home
Ecosystem

Smart Doorlock With Fingerprint Sensor

- This lock provides both security and convenience anytime and anywhere.
- It features fast fingerprint recognition, identifying users in just 1 to 1.5 seconds, making it ideal for children and elderly individuals.
- It operates on 4 AA batteries, ensuring reliable power.
- The lock is compatible with devices running Android 4.3 or iOS 7.0 and above.



Color



Black



Red Copper

Model No

L6-FP-241-W

L6-FP-246-W

Unlock
Methods



Fingerprint



Pin
Code



Card
Unlock



Mechanical
Key



APP
Unlock

Features



Energy
Efficient



Real-time
Video
Intercom



Multiple
Access
Options



Easy
Installation



Smart
Home
Ecosystem

Smart Doorlock With Facial Recognition

- The lock has a visual intercom with a peephole, allowing you to see visitors remotely on your phone or directly on the lock's screen.
- A mechanical handle on the indoor side ensures you can unlock the door manually during power failures or emergencies.
- You can manage multiple locks easily with a single phone.
- The compact design fits seamlessly with both wooden and metal doors.

Color



Black



Gold

Model No L6-FR-141-W L6-FR-144-W

Unlock Methods



Fingerprint



Mechanical Key



Pin Code



APP Unlock



Card Unlock



3D Face Recognition



Features



Energy Efficient



Multiple Access Options



Real-time Video Intercom



Smart Home Ecosystem



Easy Installation

Smart Doorlock For Glass Door



- This lock is easy to install without any drilling, requiring only external wiring and network setup.
- It is highly versatile and fits frameless or framed glass doors, single or double doors, and left or right-opening doors.
- It includes a doorbell function with real-time voice navigation and alarm features for added convenience.
- The system triggers an alarm and locks for three minutes if the wrong password is entered five times consecutively.
- It comes with a USB-compatible external backup power supply, ensuring uninterrupted functionality.

Color



Black

Model No L6-GD-151-W

Unlock Methods



Fingerprint



Pin
Code



Card
Unlock



Mechanical
Key



APP
Unlock

Features



Energy
Efficient



Real-time
Video
Intercom



Multiple
Access
Options



Easy
Installation



Smart
Home
Ecosystem

SMART SWITCHES

Our smart switches feature a durable tempered glass panel, maintaining a like-new appearance. With colourful LED indicators, they offer a modern look. Compatible with Amazon Alexa and Google Assistant, they provide seamless voice control and app functionality for enhanced convenience and efficiency.

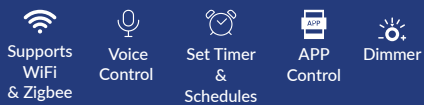

THE FUTURE IS HERE.

Explore limitless possibilities with Connectica Touch Switches exhibiting contemporary elegance.

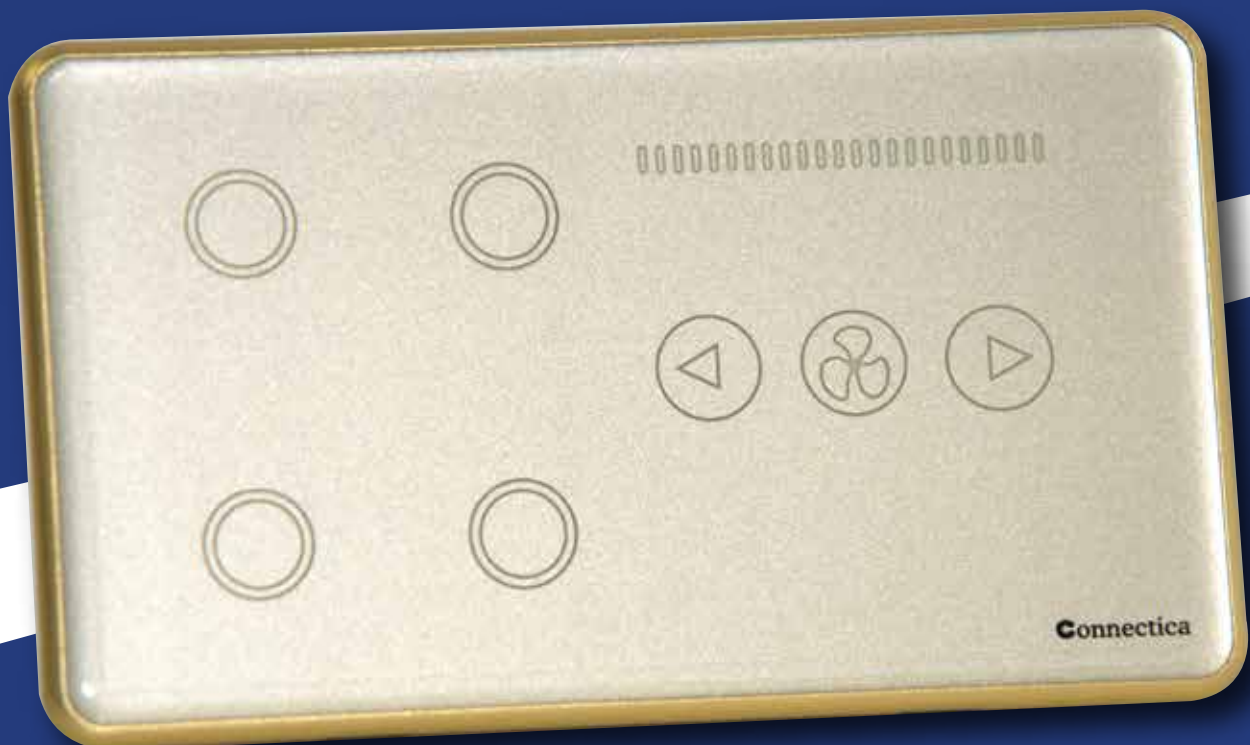

SMART SWITCH SERIES

Dimensions - 86x86x39 mm

Features



Supports
WiFi
& Zigbee



Voice
Control



Set Timer
&
Schedules



APP
Control



Dimmer



Smart Touch Switch



Wifi 4 Gang Customized
Switch



Smart Scene Switch



Smart Curtain Switch



Wall Socket &
USB Charger Switch



Smart Fan Switch

SMART SWITCH SERIES

Dimensions - 147x86x39 mm

Features



Supports
WiFi
& Zigbee



Voice
Control



Set Timer
&
Schedules



APP
Control



Dimmer

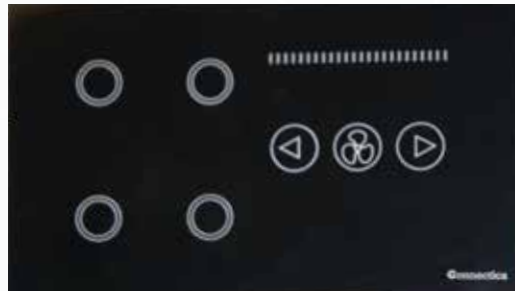

Wifi 4 Gang & Fan
Switch



Wifi 4 Gang & Socket
Switch



Wifi 6 Gang Switch



Wifi 8 Gang Switch

SMART MULTIFUNCTION SWITCH

(4 Gang + Fan + Socket + USB Charger)



Various Color Options

Built with High-quality tempered glass, the switch panels are available in Gold, Black and White colours.



Fits In Any Switch Box

Perfect for homes, offices, hotels and other environments.



Shock, Water & Fire Proof

Works with lamps, air conditioners, water heaters, chimneys, and various other appliances



2-Way or 3-Way Switch Options

Also select from various LED indicator colors for personalization.



Voice And App Control

Connect and Control via voice assistants & Mobile App anytime anywhere.

SMART SENSORS

Connectica Sensors provides proactive home security by sending mobile notifications before potential issues arise. With these advanced sensors, you'll receive timely alerts, allowing you to take action and prevent mishaps, ensuring your home remains safe and secure at all times.

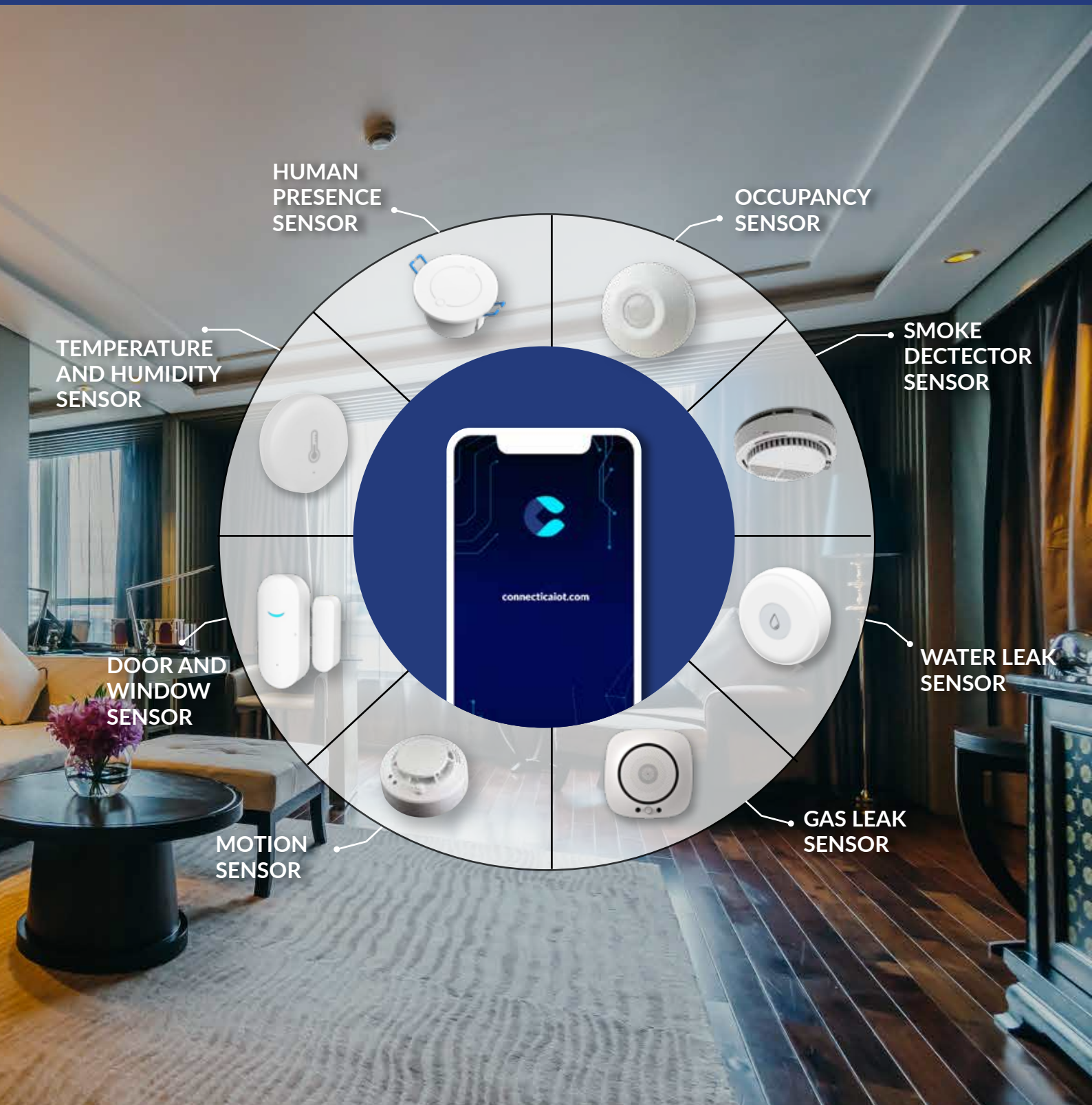



Smoke Dectector Sensor

Ensure the safety of your home with advanced smoke detector sensors. These devices continuously monitor for smoke and fire hazards, alerting you instantly through notifications and a built-in siren. Highly sensitive and reliable, they offer prompt warnings to protect your loved ones and property from potential dangers.

Water Leak Sensor

Stay ahead of water-related mishaps with our water leak sensor. It sends instant notifications when your water tank is full and, when integrated with automation products, can turn off the motor automatically. Ideal for detecting water accumulation in basements or



Gas Leak Sensor

Prevent kitchen mishaps with the real-time gas leak sensor, designed to detect cooking gas leaks instantly. Receive immediate push notifications on your phone and rely on its built-in alarm, even offline, for added safety. This sensor ensures quick action to avoid potential hazards in your home.



Motion Sensor

Enhance security and efficiency with motion sensors that manage both automated lighting and safety. Perfect for washrooms, staircases, and passages, these sensors conserve electricity by switching off unused lights and send alerts or trigger alarms when movement is detected, offering a safe and energy-efficient environment.





Door and Window Sensor

Protect your home with tamper-proof door and window sensors. Receive real-time updates on door activity via the app and alerts for unauthorized access. These sensors not only safeguard entrances but also trigger alarms to ensure your family's safety and peace of mind.

Temperature and Humidity Sensor

Keep track of your indoor environment with our temperature and humidity sensor. It monitors changes in your home's climate, sending timely notifications for adjustments. This sensor ensures a comfortable and healthy living space, helping you maintain the perfect indoor atmosphere.



Human Presence Sensor

Elevate your home's intelligence with the human presence sensor, designed to detect even subtle movements. Ideal for smart lighting and security, it ensures lights activate only when needed, conserving energy. This advanced sensor provides real-time alerts for unexpected activity, creating a safer and more efficient living environment.



Occupancy Sensor

Upgrade to smart living with our 360° Occupancy Slim PIR Motion Sensor. Featuring advanced motion detection, it ensures lights turn on/off automatically, saving energy and enhancing convenience. Perfect for indoor and outdoor use, its sleek design and durable build make it an ideal choice for modern automation solutions.





IR REMOTE CONTROLLER

One remote to control it all.

- IR Remote Controller gives you the control of any IR based remote on your Connectica app.
- One device can save you the hassle of managing many remotes for each of your appliances.
- Automate any existing AC, TV, DTH, Home theatres, Projectors or any other IR based appliances.

Your all-in-one smart remote



AC



TV



STEREO



PROJECTOR



HOME
THEATRE

& MUCH MORE



SMART CURTAINS

Connectica's smart curtains and blinds provide effortless automation through a smart app and voice assistants. We offer solutions for both blind curtains and roller shades, allowing you to control light and privacy with ease. Perfect for any space, our smart curtains enhance comfort and convenience with simple, modern control.

A person in a white robe is seen from behind, standing in front of a large window with dark curtains. They are reaching up to pull the curtains open, allowing bright sunlight to stream into the room, creating a warm and inviting atmosphere. The scene is set in a modern interior with a clean, minimalist design.

Hey Alexa!
Open The Curtains.



Easily upgrade your existing blinds or curtains to smart functionality with our customizable solutions, designed to fit any size or weight. Even during power outages, they can be operated manually. The system runs quietly and offers multiple control options, including the Connectica app, voice assistants like Google Assistance and Amazon Alexa, and RF remote. With Connectica curtain motors, you can fully open or close curtains, stop them with a button, or set them to a specific percentage position.





- High-accuracy position limit
- Internal structure is sealed and lubricated for low noise and vibration
- Overheat and overload protection
- Flame-retardant material for low fire risk Supports open, stop, close and percentage control



CONNECTICA MOBILE APPLICATION



Light & Appliances
Control



Security
Control



IR Control



Easy To Use



Customizable



Quick Control
Across The Globe

Ever wonder if you forgot to turn off the lights? With Connectica products, you can take complete control of your home right from your fingertips and anywhere in the world. Manage all your appliances through a single, easy-to-use automated platform with the Connectica App—your all-in-one home automation solution. Designed for both iOS and Android, the Connectica app makes your comfort just a touch away. Regular updates ensure a sleek interface and a smooth, hassle-free experience every time.

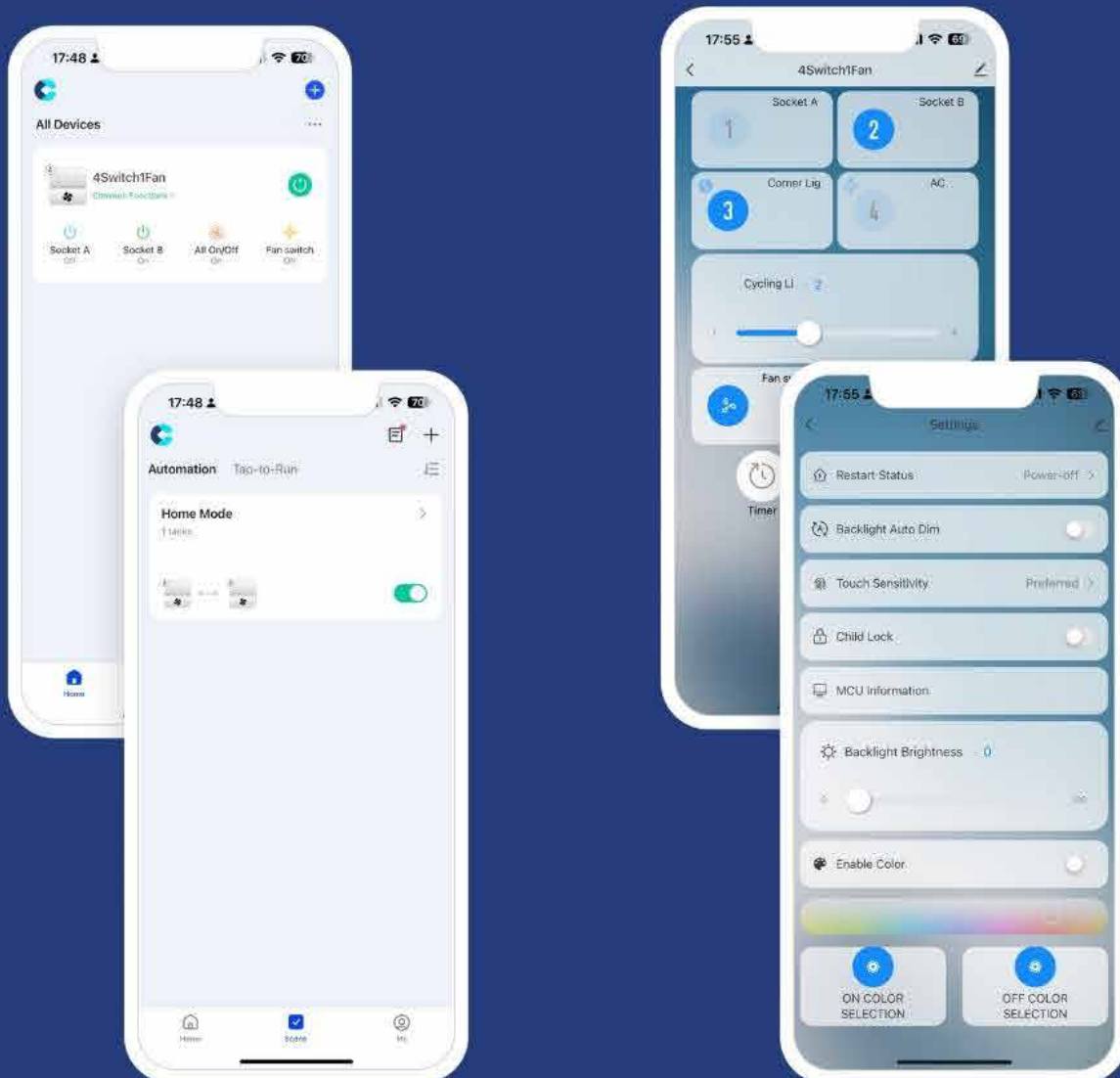

Connectica app is available on the Google Play Store and the Apple AppStore.

Google Play Store
Apple App Store

Instagram

Facebook

Linkedin

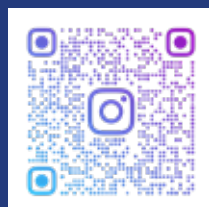

CONTACT US

Connectica IoT Pvt. Ltd

🌐 www.connecticaiot.com

📍 113 Market M3M, SCO 94, 2nd Floor, Sec-113,
Gurugram, Haryana - 122017

We Can Be Contacted At

📞 +91-9090581008

✉ sales@connecticaiot.com



<https://www.facebook.com/iot.connectica>



<https://www.instagram.com/iot.connectica/>



<https://www.linkedin.com/company/iot-connectica>



<https://www.youtube.com/@iot.connectica>